

canfield connector
8510 Foxwood Court
Youngstown, Ohio 44514
P:(330) 758-8299 F:(330) 758-8912
www.canfieldconnector.com

EiS SERIES



ELECTRONIC INCLINOMETER SENSOR

General Description

The Canfield Connector Electronic Inclinator Sensor EiS is an instrument designed to measure angles of slope, tilt, or elevation of an object with respect to gravity based on an artificial horizon. Synonyms include tilt sensor, tilt switch, clinometer, slope sensor, slope gauge, level sensor, level meter, tiltmeter or pitch and roll sensor. The EiS is an all solid-state MEMs device designed to measure tilt while reporting the data within 0.3 degrees accuracy $\pm 85^\circ$ with an analog output of .5 to 9.5 Volts DC, 4 -20mA. The unit features a miniature metal housing and is epoxy encapsulated for vibration, water and dust resistance and is rated IP67 environmental rating. Available in 1 or 2 axis versions, the unit boasts a temperature drift of $\pm 1^\circ$ maximum with a temperature range of -40 to 80° C. The EiS is precisely calibrated to remove non-linearity in the sensing range. Applications for inclinometers such as the EiS include platform leveling, motion sensing, filter vibrations, boom angle sensing, cameras, machine arm angle sensing as well as mobile security systems. The unit comes with high quality 9 ft. PVC jacketed wire, other lengths and quick connections as options, and is mounted in place by use of two 4.21mm holes.

Dimensional Data

ALL DIMENSIONS ARE IN MILLIMETERS UNLESS OTHERWISE NOTED

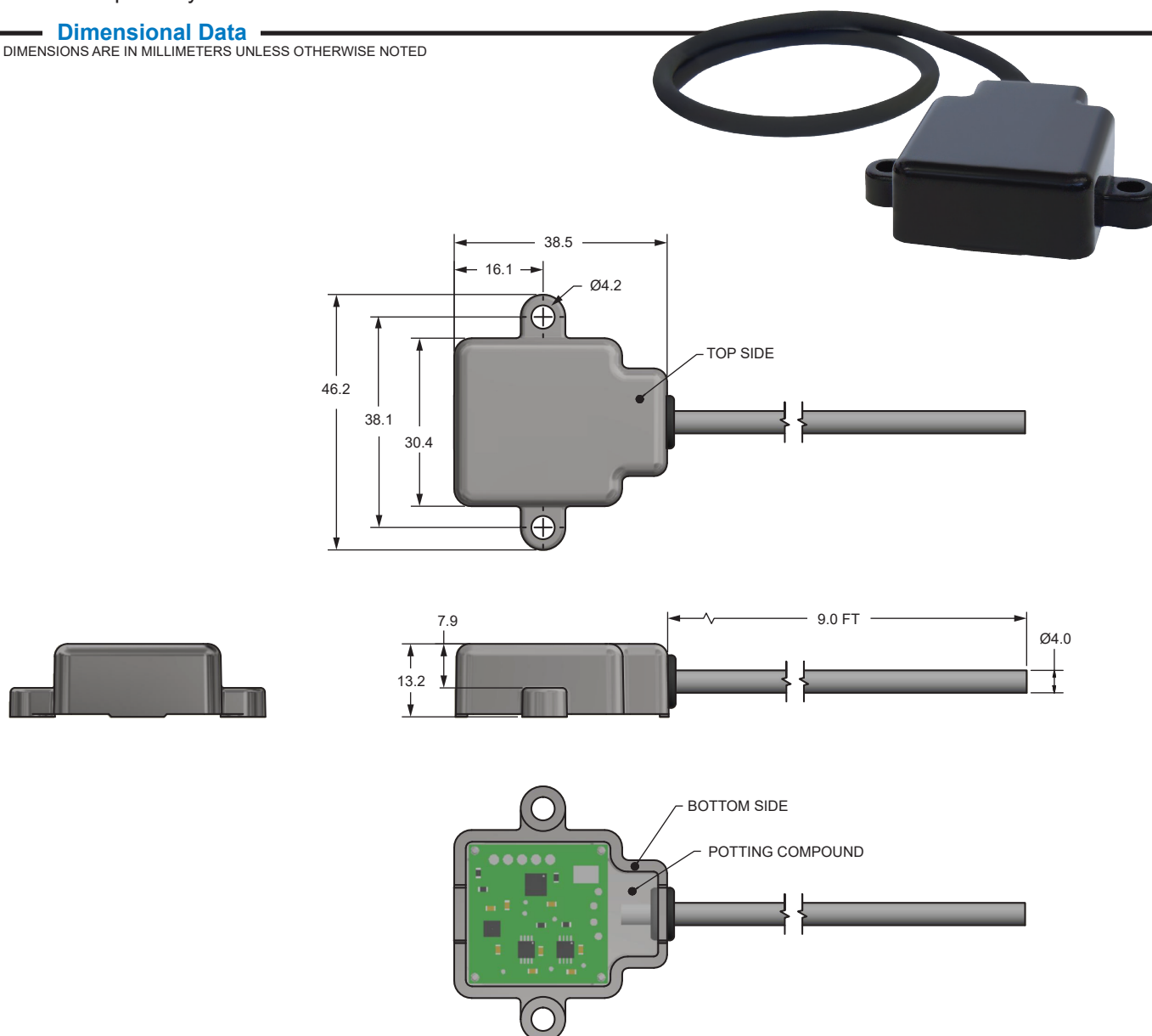

Accuracy @ 20°C	0.3°
Environmental Protection	IP 67
Materials	Cable: PVC (others available on request) Housing: Zinc die-cast Housing Finish: Black powder coat
Number of Axis	Single: 1 Dual: 2
Output Current	10 mA Maximum (Voltage Output Units)
Output Format	Analog
Output Type	0.5 - 4.5VDC 0.5 - 9.5 VDC 4 - 20 mA
Range	+/- 85°C
Supply Voltage	12-24 VDC
Temperature Drift	+/- 1° Maximum
Temperature Range	-40° to +80°C
Wire Gauge	24 AWG

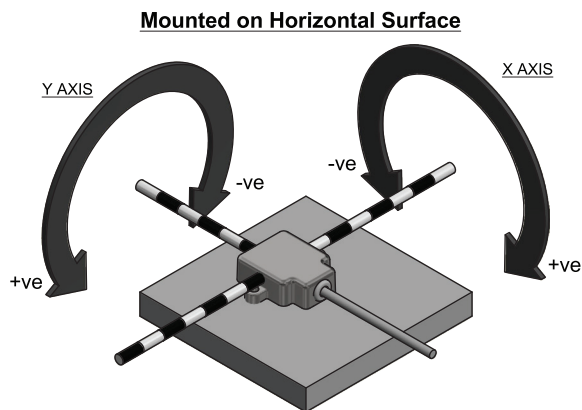

Ordering Information

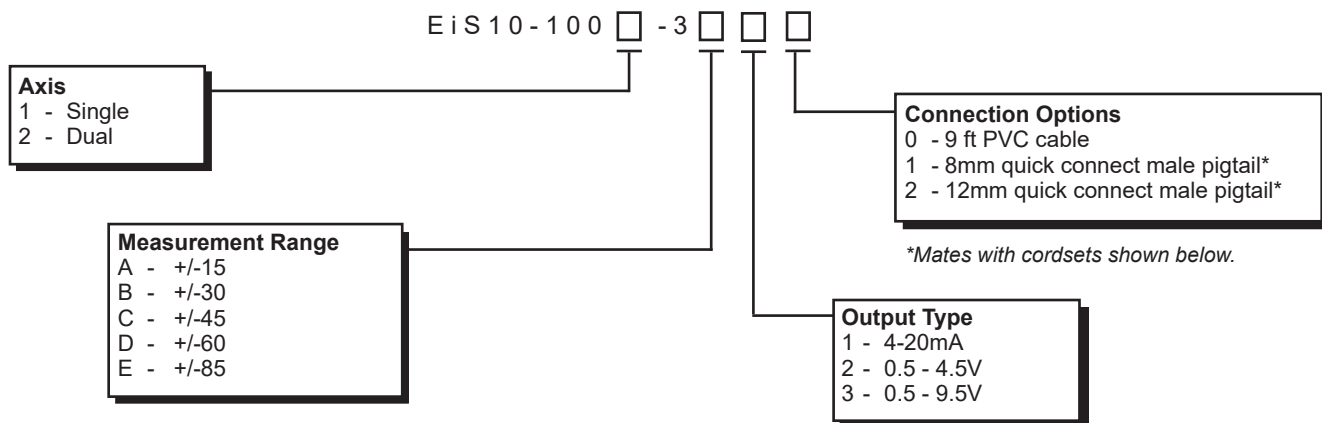

Mating Cordsets

ALL DIMENSIONS ARE IN MILLIMETERS UNLESS OTHERWISE NOTED

8mm female molded locking connectors

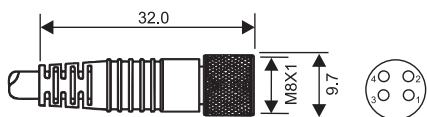

Brown = Pin 1
White = Pin 2
Blue = Pin 3
Black = Pin 4

Order part number
RC08S-F0M040120 (2m length)
RC08S-F0M040150 (5m length)

12mm female molded locking connector

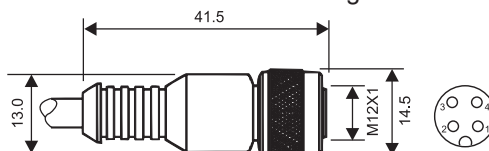

Brown = Pin 1
White = Pin 2
Blue = Pin 3
Black = Pin 4

Order part number
RC12S-F0M040120 (2m length)
RC12S-F0M040150 (5m length)

Ordering Example: EiS10-1001-3A10

Single Axis, +/-15 Range, 4-20mA, 9 ft. PVC cable.